

ESAC34M-02C (10A)

SOFT RECOVERY SUPER HIGH SPEED

Outline Drawing

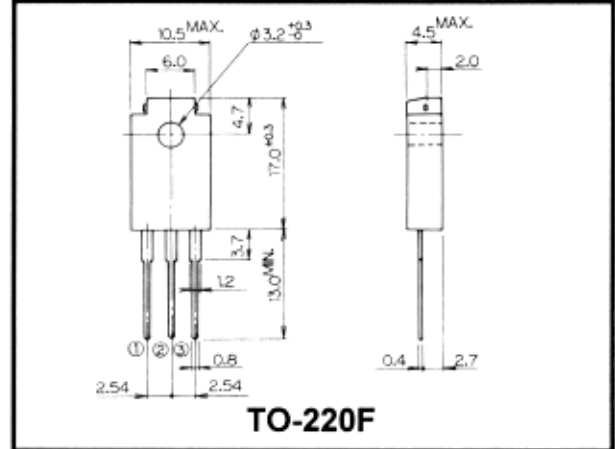

Connection Diagram

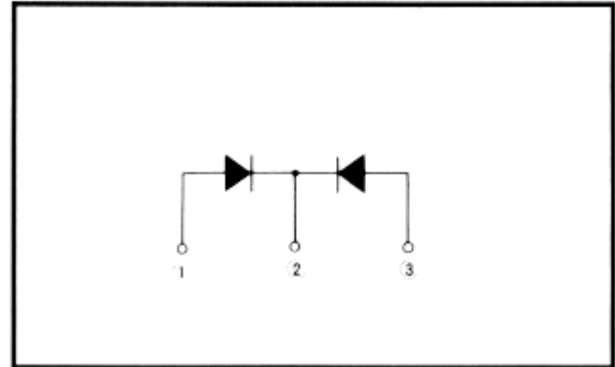

Features

- Insulated package by fully molding
- Soft recovery, low noise
- High reliability

Applications

- High speed power switching

Maximum Ratings & Characteristics

- Absolute Maximum Ratings

Items	Symbols	Conditions	Ratings	Units
Repetitive Peak Reverse Voltage	V_{RRM}		200	V
Non-repetitive peak reverse voltage	V_{RSM}		220	V
Average Output Current	I_O	$T_C = 100^\circ\text{C}$, Sq. Wave, duty = 1/2	10*	A
Surge Current	I_{FSM}	Sine Wave, 10ms	50	A
Operating Junction Temperature	T_J		-40 to +150	$^\circ\text{C}$
Storage Temperature	T_{stg}		-40 to +150	$^\circ\text{C}$

*Average forward current of centertap full wave connection

- Electrical Characteristics ($T_a = 25^\circ\text{C}$ Unless otherwise specified)

Items	Symbols	Conditions	Ratings	Units
Forward Voltage Drop	V_F	$I_F = 5\text{A}$	1.4	V
Reverse Current	I_R	$V_R = V_{RRM}$	100	μA
Reverse Recovery Time	t_{rr}	$I_F = 0.1\text{A}$, $I_R = 0.1\text{A}$	100	ns
		$I_F = 0.1\text{A}$, $I_R = 0.2\text{A}$, $I_{rec} = 0.05\text{A}$	45	
Thermal Resistance	$R_{th(j-c)}$	Junction to case	3.5	$^\circ\text{C/W}$

ESAC34M-02C (10A)

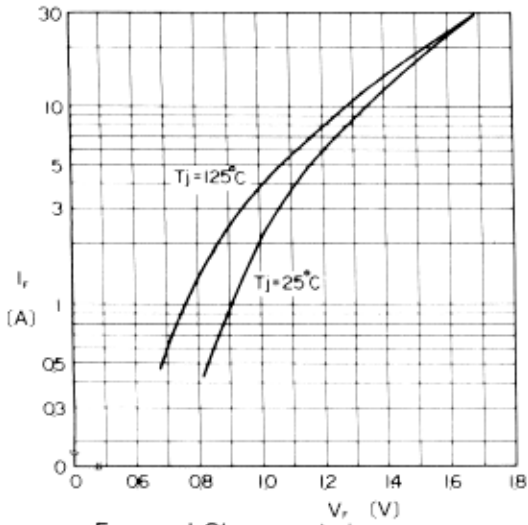

Forward Characteristics

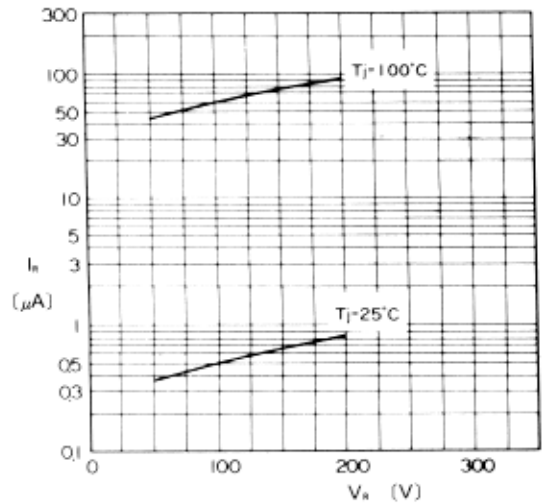

Reverse Characteristics

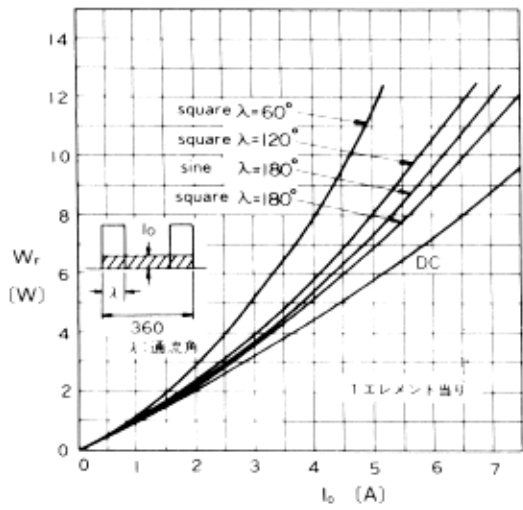

Forward Power Dissipation

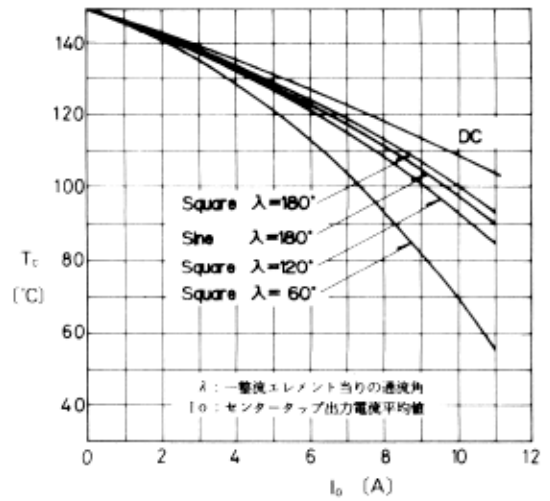

Output Current-Case Temperature

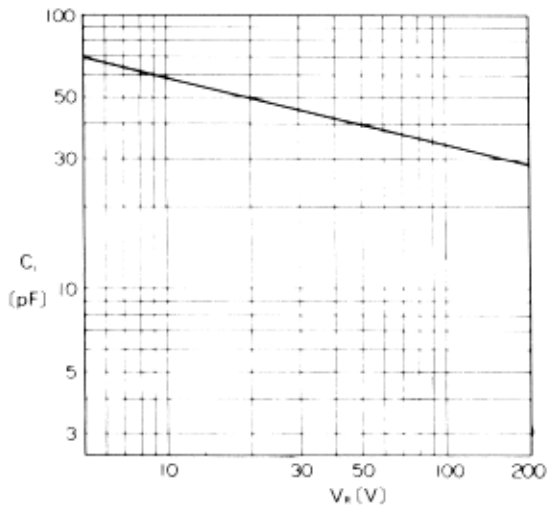

Junction Capacitance

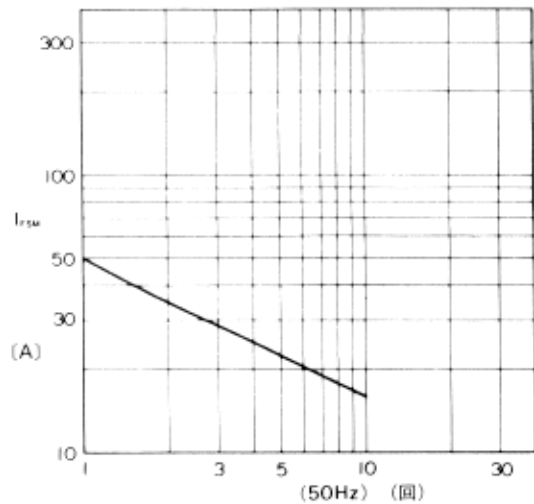

Surge Capability